

NEW

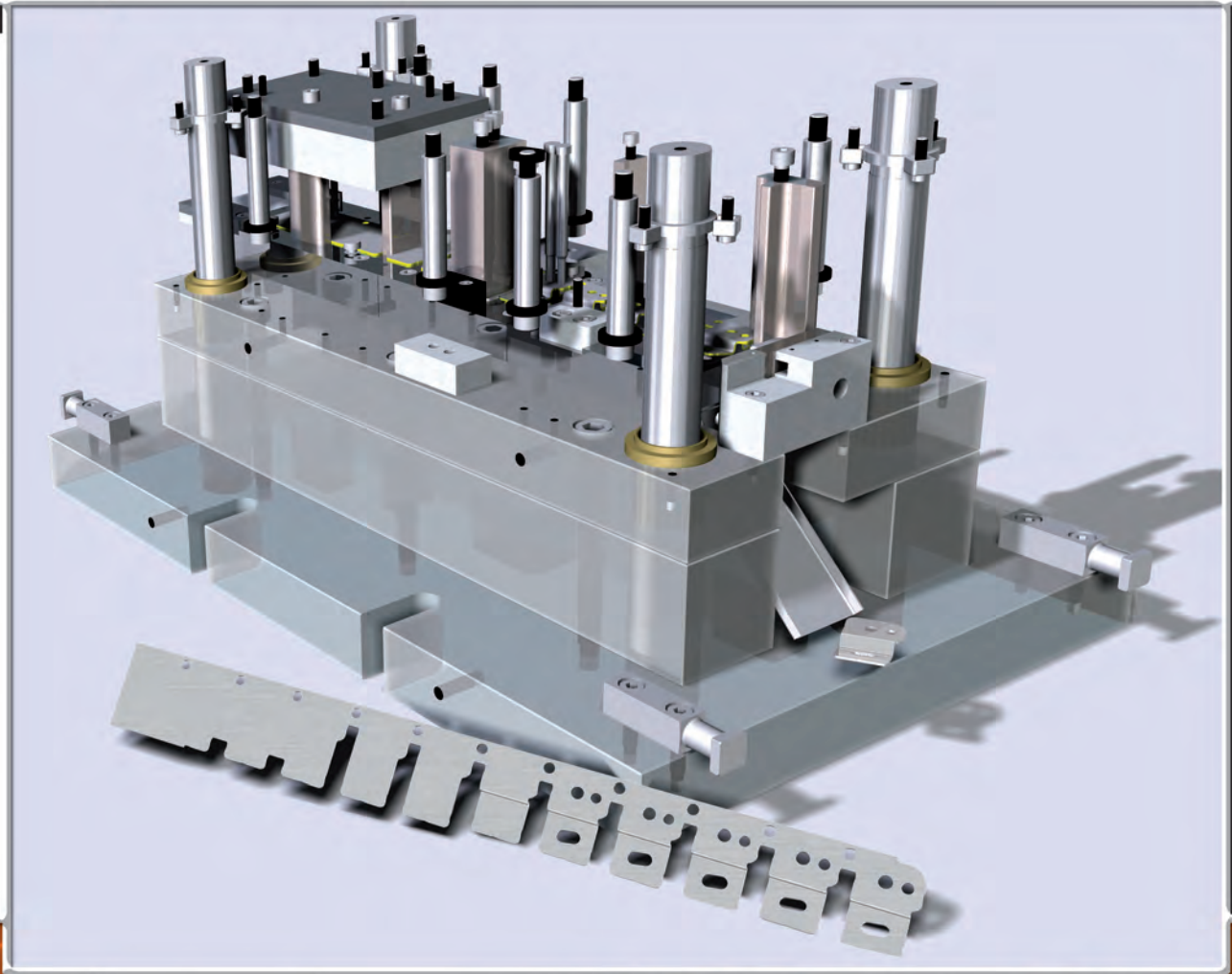

Excellent **CAD/CAM** for tool makers

- Advanced calculation functions for intermediary unstamping stages
- Copy an unfolded part with symmetry or rotation
- Possibility to invert the strip direction
- Strip layout creation from 3D to 2D for the treatment of complex parts
- Strip layout creation for transfer tools
- Cutting operations that conserve losses
- New methodology for forces analysis
- Improved performance for components calculation
- Team Design Wizard for collaborative work

TopSolid'Progress 2008



The dedicated CAD solution for progressive die and press tool designers.

In addition to incorporating all those functions standard to TopSolid, TopSolid'Progress enables the successful blanking of a sheet metal part and the design of the strip in half the time needed by a standard CAD software. The software manages all cutting, folding and deforming stages of the sheet metal, creation of the die set, addition of standard components together with their machining processes, creation of punches, non-standard matrices and draft creation. Discover the principal improvements of the 2008 version, among the many new functions this version has to offer.

Part preparation / Unfolding

- Numerous improvements in the treatment of local unfolding operations
- Copy an imported folded part with symmetry or rotation

Strip creation

- Management of the strip in the X+ or X- direction
- Strip creation from 3D to 2D for the treatment of complex parts
- Strip creation without adding matter for the design of transfer tools

Strip creation operations

- Keep strip losses generated in cutting operations
- Possibility to determine the depth of manual cutting operations (semi-punching)
- Move some pieces of the part (folding / unfolding / free movement)

Tools

- Redefined force analysis function

Die bases

- Catalogues of standard die bases in Excel format

Components

- Important improvement in performances (components server)
- Component bookmarks or favorites
- Component configuration by default depending on component properties
- Process activation can be set off on an auxiliary shape
- Enriched standard libraries

Tools and dies

- Table of predefined diameters to round automatically the dimensions of the circular removals
- Composite surface to design forming punches and stamping dies

Methodology

- Team Design Wizard to work in collaborative mode. Manage the sharing of common elements and sub-assemblies and the re-assembly of all elements at the end

Draft creation

- Open book projection mode in vertical direction
- Automatic creation of drilling tables during multi-draft creation

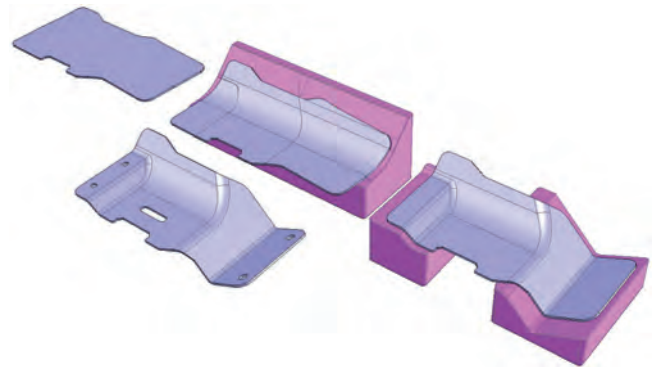

Local unstamping: you can now easily manage intermediary stages.



Forces analysis visualisation with TopSolid'Progress 2008.

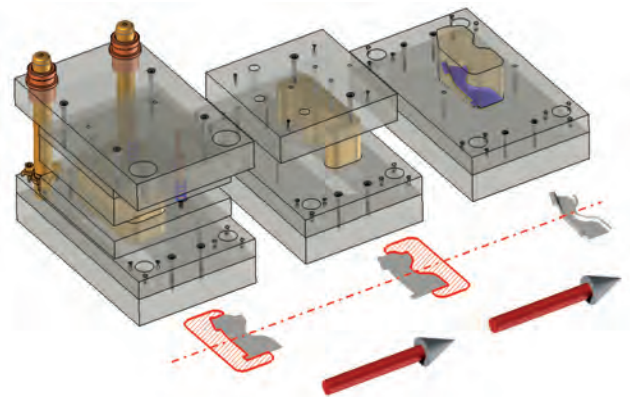

The transfer tool enables strip management without adding matter.

Missler Software

7, rue du Bois Sauvage - 91055 Evry, France
Tel: +33 (0)1 60 87 20 20 - Fax: +33 (0)1 60 87 20 18
E-mail: international@topsolid.com

