

TopSolid

Progress

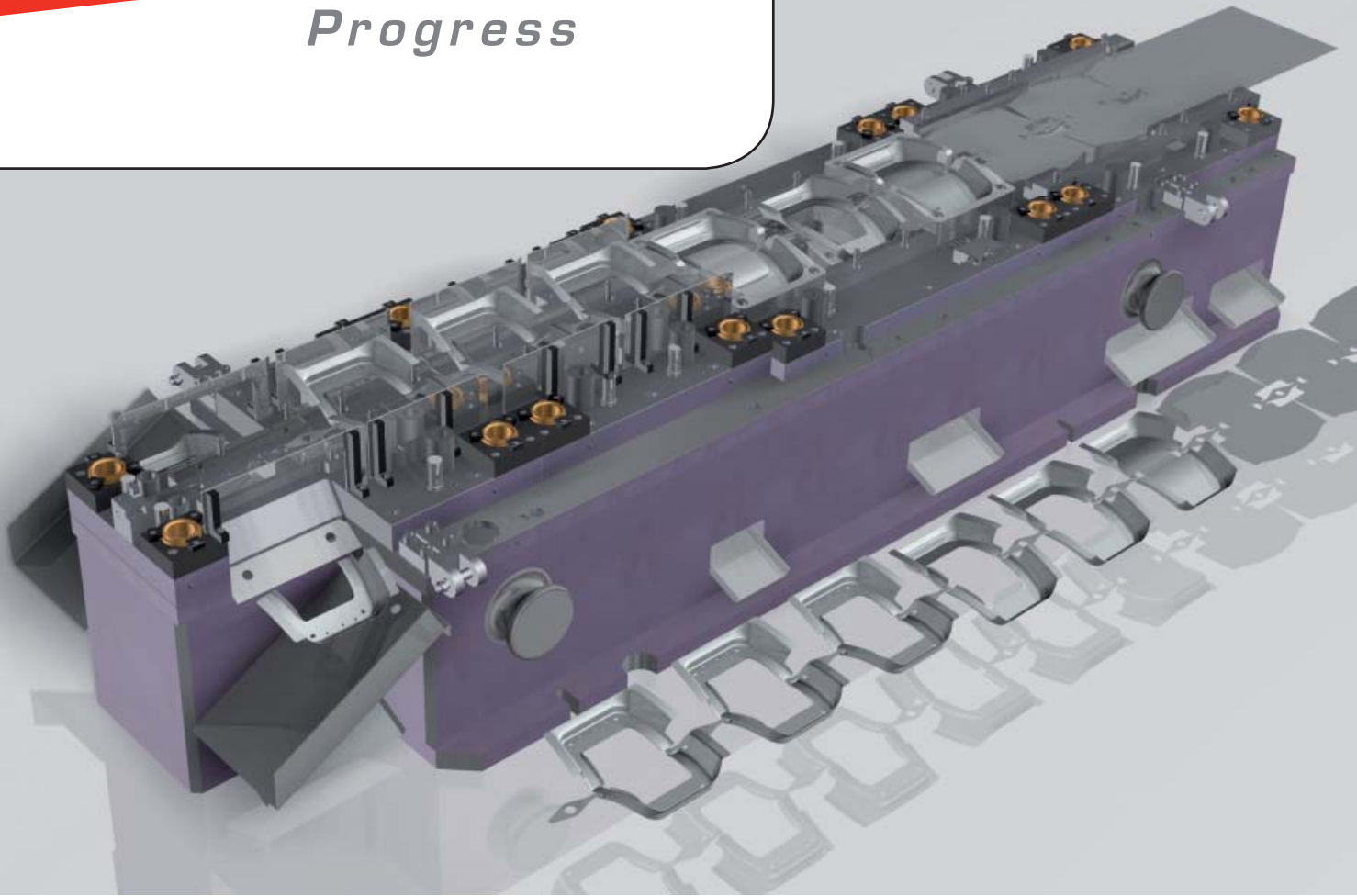

A complete CAD/CAM solution for progressive die and press tool designers

- Get external 3D numerical data
- Quickly calculate blanks
- Define the strip layout, cutting, bending and deformation operations
- Work with rich libraries of die bases and standard components
- Design springs, inserts, punches and dies with their clearance values and tolerances
- Simulate tool movements
- Generate drafts, BOMs and drill tables
- Directly machine all parts

THE INTEGRATED
CAD/CAM/ERP SOLUTION

Here are some of the major improvements of TopSolid'Progress 2009

TopSolid'Progress provides all the required functions to help designers compute sheet metal part blanks, design the strip layout and dies far faster than with a standard CAD software.

Here are some of the big improvements of TopSolid'Progress 2009

Part preparation / Unfolding

- > Leading surfaces are associative. Lateral extensions are possible
- > Management of parts with null internal bending radius

Strip creation

- > Deep drawn parts creation and management, wizard to calculate the number of stages needed, dedicated components
- > New way to define stations (contour curve)

Strip creation operations

- > Controlled update of stations

Die bases

- > Management of vertical spaces between plates

Components

- > Pre-visualisation of components during insertion
- > Reproduce function: dimensions, clearances and visual attributes
- > Automated hooking on named faces

Punches and dies

- > Punches: centered cutting wave, fixing key groove
- > Overbending management: K factor value, unrolling mode
- > Bending punches and dies: overbending management by shifting
- > Clearance function: management of local clearances as well as the main clearance. Advanced radius treatment
- > Management of clearance on profiles
- > Corner relief [symmetrical or asymmetrical], mistake proofing
- > Finish die clearing, vertical fillets

Tools

- > Visualisation: BOM index displaying

Draft creation

- > Aligned section
- > Compact drill tables, symbols

Closer links with TopSolid'Wire

- > Manage push pointing diameter in machining properties function
- > Management of slave parts

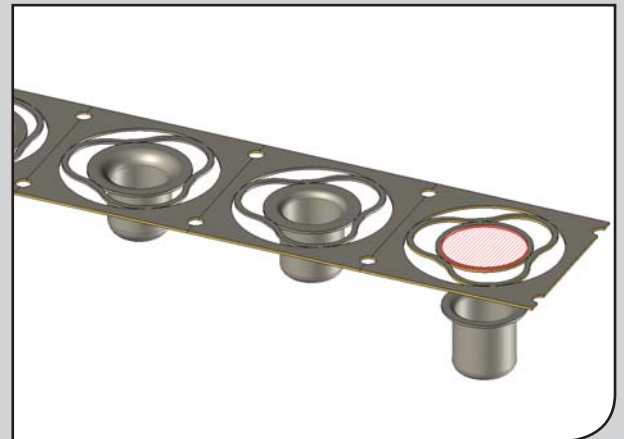

Management of deep drawn parts.

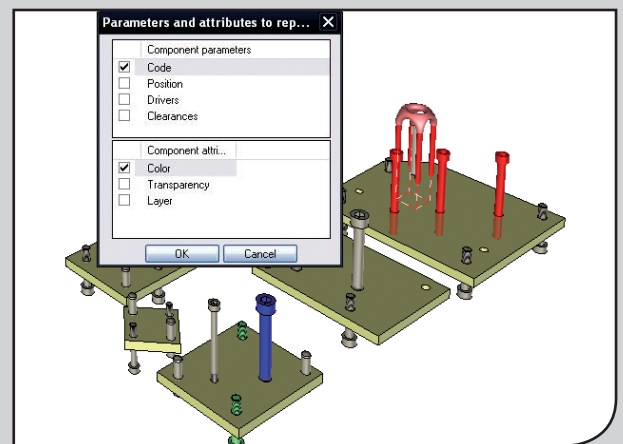

Assisted copy of component characteristics (attributes, clearances...).

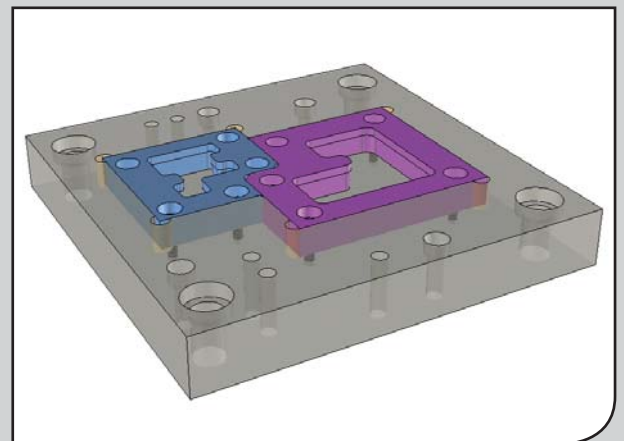

Corner relief samples in wire machining.

www.topsolid.com

THE INTEGRATED
CAD/CAM/ERP SOLUTION